

# SONIC

## LITE

BY VENTURE RV

### Travel Trailers



#### Living room/kitchen

- Roller Ball Bearing Drawer Guides
- Safe "T" EK Box
- High Efficiency LED Lighting
- Flip Side Reversible Cushions
- Mocha Latte Mosaic Backsplash
- (2) Interior Speakers
- 82" Interior Height
- Skylight
- Designer Carefree Linoleum w/3 Year Warranty
- Pleated night shades
- Shoe Cubby
- Lux Maple Mortise and Tenon Hardwood Doors

#### Bathroom

- High Efficiency LED Lighting
- Foot Flush Toilet
- Lux Maple Mirrored Medicine Cabinet w/Storage
- Power Vent
- Skylight Shower /Tub Surround
- Designer Shower Curtain

#### Bedroom

- High Efficiency LED Lighting
- Memory Foam Mattress
- Designer Valances
- Pleated Night Shades
- Designer Padded Headboard
- Quilted Reversible Comforter
- Over Head Storage
- Shirt Closet(s)

#### Exterior/construction standards

- High Efficiency LED Lighting
- One Piece Seamless Fiberglass Roof
- Easy exchange 20# LP Tank
- Large Pass-Thru Storage
- Lighted Safety Step
- Norco-BAL E-Coated and Epoxy Painted Huck Bolted Frame
- Five Sided Champagne Color Infused Fiberglass
- Tinted Safety Glass Windows
- Aluminum Framed Floor, Sidewalls and Roof
- (2) Marine Grade Speakers

- Large Bumper with Sewer Hose Storage
- Satellite and Cable Hookup
- Porch Light
- Water Heater By-Pass Valve
- Tank Monitor System
- Marine Style 30Amp Power Cord with light
- 6 Gallon DSI gas/Electric Water Heater

#### Exterior Luxury (Mandatory option)

- High Polished Aluminum Rims
- (4) BAL Scissor Jacks w/ Foot Pads
- Motorhome Lighted Grab Handle
- Blank Tank Flush
- Prewire for ZampSolar
- Prewire for Backup Camera
- Motorhome Style Slam Latch Baggage Doors
- Multi Directional LED Lighted Power Awning
- Exterior Shower w/ Hot and Cold Water

#### Interior Luxury Package (Mandatory Option)

- Bluetooth DVD/CD/MP3/AM/FM Stereo w/Remote
- 4.2 Refrigerator
- 2-Burner Cooktop
- Convection Microwave
- Vented Range Hood
- Residential 8,000BTU A/C

#### Options

- LED TV w/Swing Arm Bracket
- Low Profile 13.5 AC
- Lighted Power Tongue Jack w/ Level
- Spare Tire, Carrier and Cover

## 2016 Décor



Black Diamond



Summit

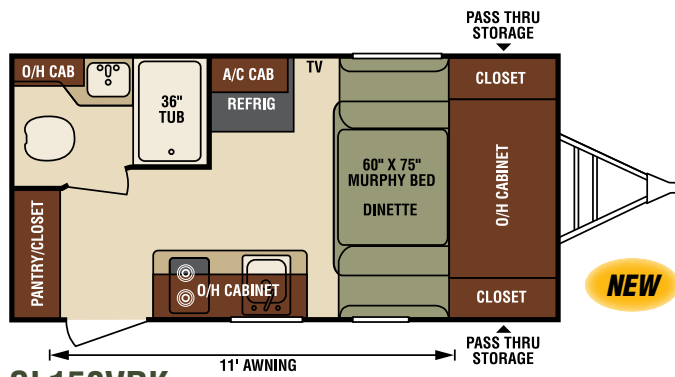

**SL150VRK**

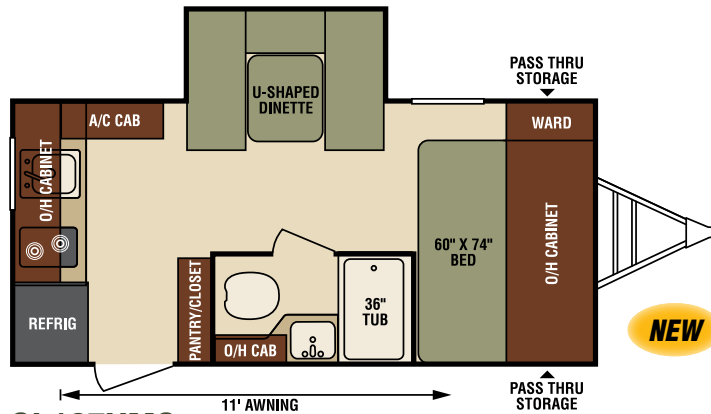

**SL167VMS**

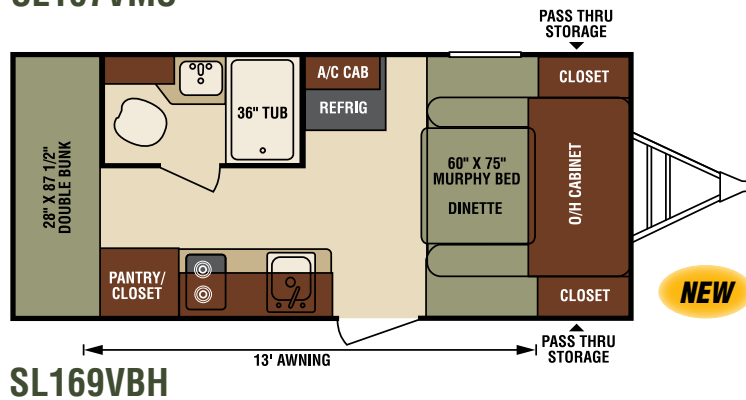

**SL169VBH**

### Travel Trailers

	SL150VRK	SL167VMS	SL169VBH
UVW (Unloaded Vehicle Weight)*	2,480	2,898	TBD
Dry Hitch Weight*	270	350	TBD
Dry Axle Weight*	2,210	2,548	TBD
NCC (Net Carrying Capacity)	1,020	1,102	TBD
GVWR	3,500	4,000	TBD
Interior Height	82"	82"	82"
Exterior Height	9' 5"	9' 5"	9' 5"
Exterior Width	90"	90"	90"
Exterior Length	19' 2"	20' 4"	21' 3"
Refrigerator (Cubic Feet)	4.2	4.2	4.2
Water Heater Cap. (Gal. G/E w/DSI)	6	6	6
Fresh Water Capacity (Gallon)	39	39	39
Black Water Capacity (Gallon)	30	30	30
Gray Water Capacity (Gallon)	30	30	30
LP Gas Capacity (Lbs.)	20	20	20
Furnace BTUs (1,000s – OPTIONAL)	16,000	16,000	16,000
Tire Size	14"	15"	14"
Awning	11'	11'	13'

\*This weight reflects the rolling average unit weight for each model. Your trailer weight will vary according to optional equipment.



985 N 900 W • Shipshewana, IN 46565  
[www.venture-rv.com](http://www.venture-rv.com)

Due to continual research and advances, manufacturer reserves the right to change specifications, design, price and equipment without notice, and assumes no responsibility for any error in this literature. Some items shown are not included as standard or optional equipment. ©2015 Venture | 9/15/15 | 5M